



THIS PHOTO: Soft gray-green painted cabinetry and custom Roman shades give this cottage-style kitchen a high-end look. A peninsula replaces a bulky island, creating better flow in the work zone and a convenient place to eat.

team effort

Homeowner research and designer know-how yielded this chic—yet cost-effective—makeover.

WRITER AND FIELD EDITOR LISA MOWRY
PHOTOGRAPHER EMILY J. FOLLOWILL



OPPOSITE: Window frames are painted to match the cabinets. The subway tile below is laid in a herringbone pattern. **THIS PHOTO:** Locating the range in the peninsula lets the cook chat with guests, glance out the window, or watch the undercabinet TV.



handy homeowners

Kristin and Matt Olson of Atlanta knew they needed help to update the kitchen in their first house.

Kristin wasn't sure of the best way to allocate the couple's budget and space. "We'd been living there a year, but I was hesitant to make design decisions," she says. Then the couple found designer Capella Kincheloe on the Web.

Kincheloe helped the Olsons plan the best use of space in their kitchen and adjacent rooms. She called for a U-shape kitchen, getting rid of the obstructive island and taking the cabinets to the ceiling for more storage. Kristin then retained Kincheloe for additional consultations to help pick out the cabinets, countertops, hardware, barstools, and appliances. "The only thing we reused in the kitchen was the refrigerator, which we purchased new right after we bought the house," Kristin says. "Everything else needed updating."

While she hadn't been able to make decisions, Kristin had saved a magazine page of her dream kitchen. "It was a farmhouse style with Shaker-style cabinets and light countertops," she says. "We used that as our inspiration, but our budget helped guide us to make some other decisions." The Olsons had wanted custom cabinets, for instance, but were able

to find stock cabinetry that met their needs from a local home-supply warehouse. They also got a discount on their quartz-surfacing countertop there.

"We took ordinary materials and did something special with them," Kincheloe says, citing the display shelves made from stock materials and the white ceramic subway tiles laid in a herringbone pattern for a sophisticated twist. Best of all, Kristin and Matt, who works in construction, saved on labor costs by installing the tile themselves.

Even talented do-it-yourselfers know when to fold, however. "Kristin found out that—while she is an incredible seamstress—Roman shades should be left to the professionals," Kincheloe says. The richly patterned window coverings made by a craftsman found at etsy.com were a bit of a splurge.

The couple love the results and that they can work side by side in the kitchen now. "It's sometimes hard to believe it's even the same room," Kristin says. "I think it looks more expensive than what we actually paid."

RESOURCES BEGIN ON [PAGE 108](#).



Personalize your kitchen with details such as a pretty fabric or an interesting pattern in tile.

about this makeover

OPPOSITE: A bit of wall space between the kitchen and family room provided an ideal location for this beverage center/cookbook display. **BELOW LEFT:** Rustic stools bring earthy texture to the new peninsula. **BELOW RIGHT:** White quartz-surfacing creates a hardworking countertop. **BOTTOM LEFT:** Large-scale brackets that support the shelves contribute to a custom look. **BOTTOM RIGHT:** “I often recommend covering ugly folding doors with chalkboard paint,” designer Capella Kincheloe says of the new look for the pantry.



budget

Appliances

Dishwasher	500
Range	2,800

Cabinetry

Cabinets	6,000
Hardware	110

Plumbing

Faucet	200
--------	-----

Surfaces

Backsplash tiles	200
Countertop	3,400
Flooring	1,735

Miscellaneous

Roman shades	600
Shelves, brackets	100

Total **\$15,645**

Costs do not include labor unless noted.

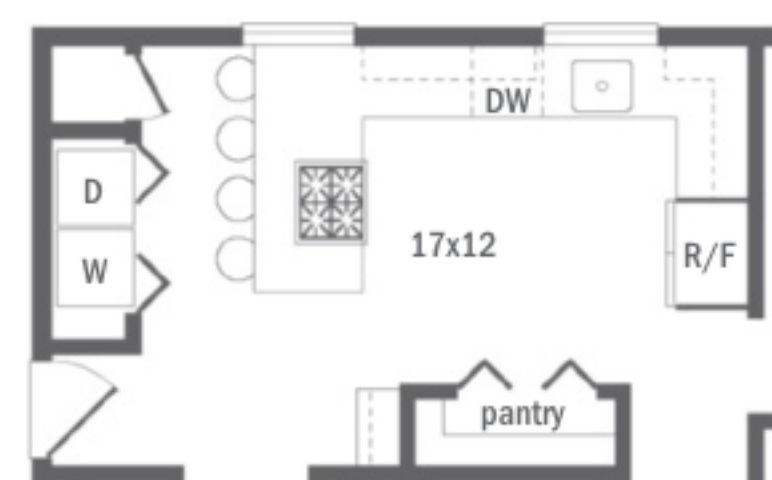

To create a more open floor plan, the designer eliminated the existing island and added a peninsula, which provides seating as well as a place for the range. The pantry with bifold doors stayed, which is where the homeowners keep the microwave.

ordinary shelves and brackets create custom storage.

